

Brass Drain Technical Specifications

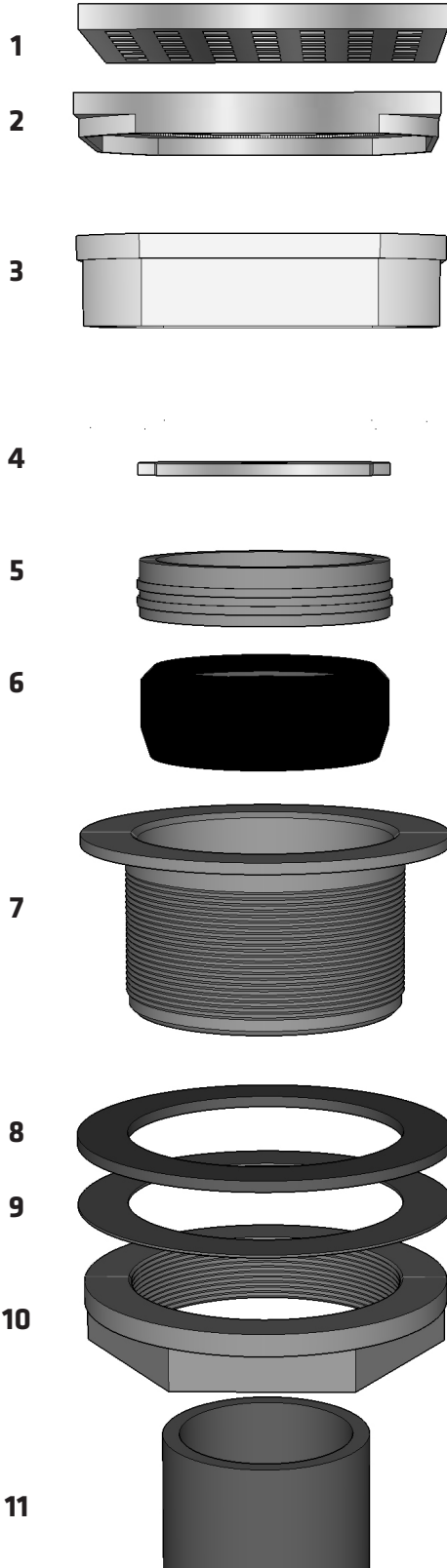

| NO. | PART NAME | MATERIAL |
|-----|----------------|-----------------|
| 1 | Drain Cover | Stainless Steel |
| 2 | Drain Tray | Stainless Steel |
| 3 | Riser | Plastic |
| 4 | Locking Key | Steel |
| 5 | Locking Nut | Brass |
| 6 | Pipe Gasket | Rubber |
| 7 | Drain Body | Brass |
| 8 | Gasket | Rubber |
| 9 | Gasket | Fibre |
| 10 | Drain Body Nut | Brass |
| 11 | Drain Pipe | |

SPECIFICATIONS

Outer locknut design with no-caulk (compression gasket) connection for 2" ABS/PVC pipe.

Stainless steel drain cover (strainer) meets all applicable load and flow requirements for intended use.

Designed in accordance with
ASME A112.18.2-2005 / CSA B125.2-05.

Drain Cover LOAD RATING 300 lbs. (19 gauge)
Drain Cover FREE AREA 3.5 in²
Drain Cover FLOW CAPACITY 8 GPM (30 l/min)

DIMENSIONS

A: top diameter 4¼"

B: overall height 2"

C: connection 2" no-caulk (compression gasket)

